

Digital Beam Load Cell – Type SDM70



Special Features

- Stainless steel
- Robust capacitive technology
- Patented high reliability capacitive sensor
- OIML R60 accuracy classes up to C5
- High tolerance of up to 1.000% overload
- Hermetically sealed to IP68
- Laser welded
- High accuracy, High resolution
- Digital filters
- Cable length up to 100meters
- Calibration independent of cable length
- Load cell cable replaceable
- Easy mechanical and electrical installation
- Withstands welding voltages and ESD



Applications

- Dynamic weighing
- Process weighing
- Mobile weighing
- Vibration feeders
- Big-bag equipment
- Hopper scales
- Conveyor scales
- Heavy duty platform scales
- Heavy duty applications
- Offshore applications



Order information

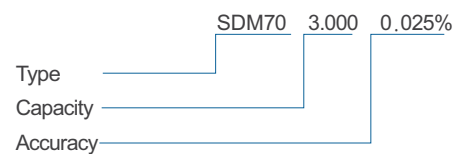

Options

- Mounting kits available
- Customized versions available
- Load cell cable length 10, 20, 50 or 100meters

Digital Beam Load Cell – Type SDM70

Dimensions (mm)

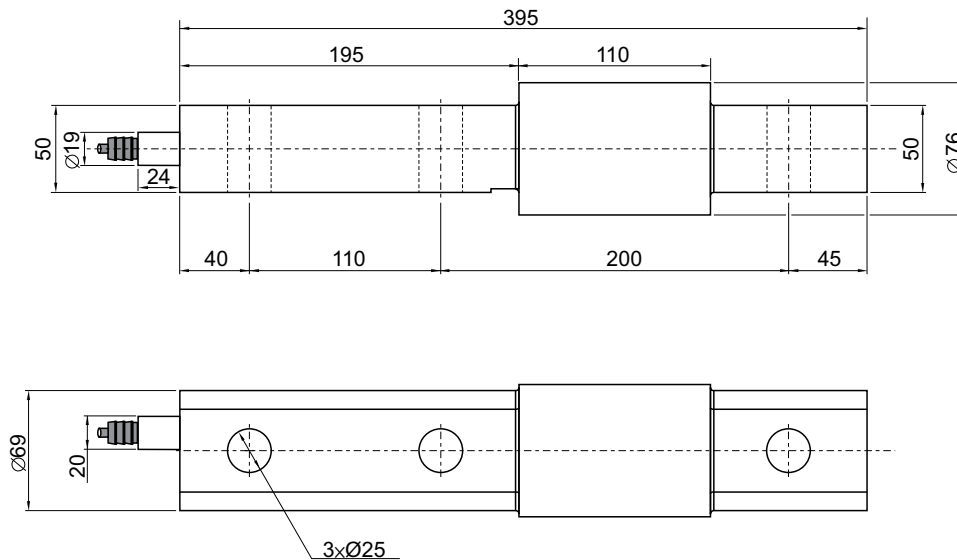

| Parameter | Unit | 0.10% C1 | 0.05% C2 | 0.025% C3** |
|------------------------------------|-----------------------|--|----------|-------------|
| Rated capacity (E _{max}) | kg | 1.000, 2.000, 3.000 | | |
| Safe overload limit | % of E _{max} | 300 to 1.000 | | |
| Safe sideload limit | % of E _{max} | 500 to 1.000 | | |
| Minimum dead load | % of E _{max} | 0 | | |
| Accuracy | % of E _{max} | 0.100 | 0.050 | 0.025 |
| Max. number of load cell intervals | N _{max} | 1.000 | 2.000 | 3.000 |
| Repeatability | % of E _{max} | 0.025 | 0.020 | 0.010 |
| Hysteresis | % of E _{max} | 0.033 | 0.020 | 0.016 |
| Creep 30 min. | % of E _{max} | 0.040 | 0.025 | 0.016 |
| Temperature effect on zero | % /10°C | 0.045 | 0.030 | 0.016 |
| Temperature effect on sensitivity | % /10°C | 0.045 | 0.030 | 0.016 |
| Compensated temperature range | °C | -10 to 50 | | |
| Operating temperature range | °C | -50 to 80 (100*) | | |
| Deflection at E _{max} | mm | Max 0.10 | | |
| Measuring rate | Hz | 200 | | |
| Supply | Vdc | 24Vdc ±10% | | |
| Internal resolution | Bit | 24 | | |
| Material | | Stainless Steel 17-4 PH and AISI 316 | | |
| Protection | | IP68 | | |
| Cable | | 6meter standard coaxial RG-58 (Ø6mm) with BNC connector | | |
| Maximum cable length | m | 100 | | |
| Weight | kg | 9.5 | | |
| Output options | | Profibus DP, DeviceNet, Modbus ASCII/RTU, EtherCAT EtherNet/IP, RS232, RS485/422, 4-20mA, 0-10Vdc | | |

* with Teflon cable

** higher accuracies available on request